



M
THE CENTRE
LIVINGSTON

Play, eat & shop
TOGETHER

Coming Soon In 2026



hollywood bowl



Marble
Global Buffet

THE CENTRE

The Centre Livingston boasts 1 million sq.ft of retail and leisure space in the seat of Scotland's commercial heartland. With 166 stores, restaurants, cafés and state of the art leisure attractions it attracts a thriving catchment with an average annual household spend 6% above the Scottish average.

M

THE CENTRE
LIVINGSTON



1m
sq.ft (92,903 sq.m) of
Retail and Leisure

7,200
Car Parking Spaces



166
Stores, Restaurants,
Cafés & Leisure

15.7m
Annual Footfall



LEISURE QUARTER PLAN

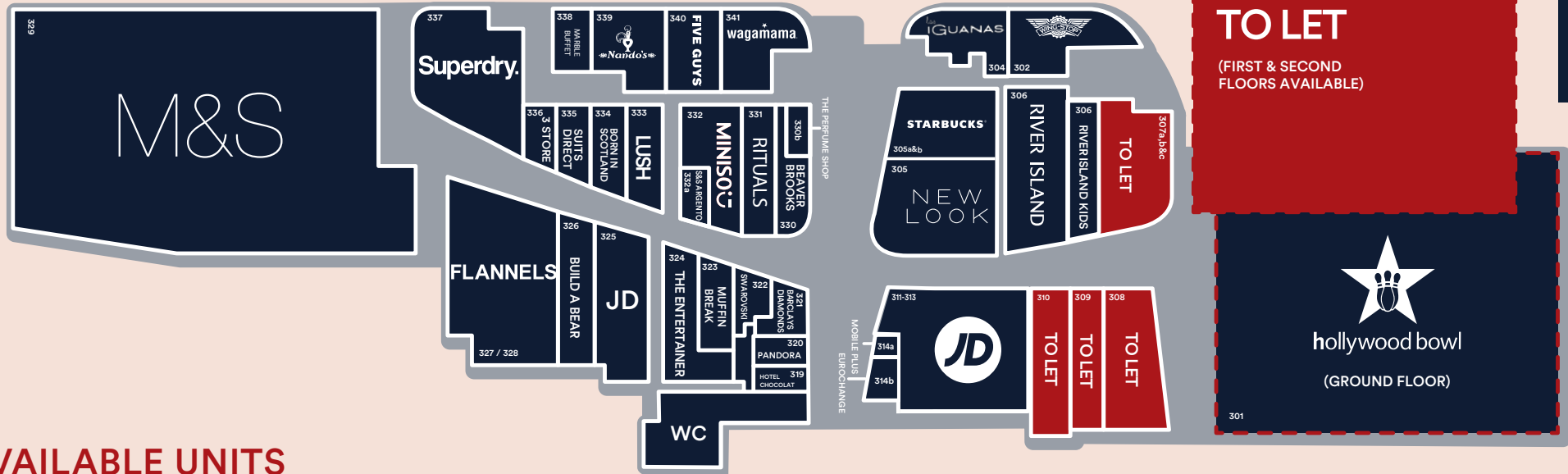

TO LET
(FIRST & SECOND FLOORS AVAILABLE)

hollywood bowl
(GROUND FLOOR)

AVAILABLE UNITS

UNIT 307 F&B and leisure users

UNIT 307a	sq.ft	sq.m
Ground Floor	1,991	185
RENT	£62,500	
RATEABLE VALUE	POA	
SERVICE CHARGE	£16,287.71 + VAT	
INSURANCE	£1,624 + VAT	

UNIT 307b	sq.ft	sq.m
Ground Floor	1,140	106
RENT	£40,000	
RATEABLE VALUE	POA	
SERVICE CHARGE	£9,325.96 + VAT	
INSURANCE	£927 + VAT	

UNIT 307c	sq.ft	sq.m
Ground & First Floor	6,651	618
RENT	£62,500	
RATEABLE VALUE	POA	
SERVICE CHARGE	£52,331.74 + VAT	
INSURANCE	£5,209 + VAT	

Can be split with multiple options - contact us for details

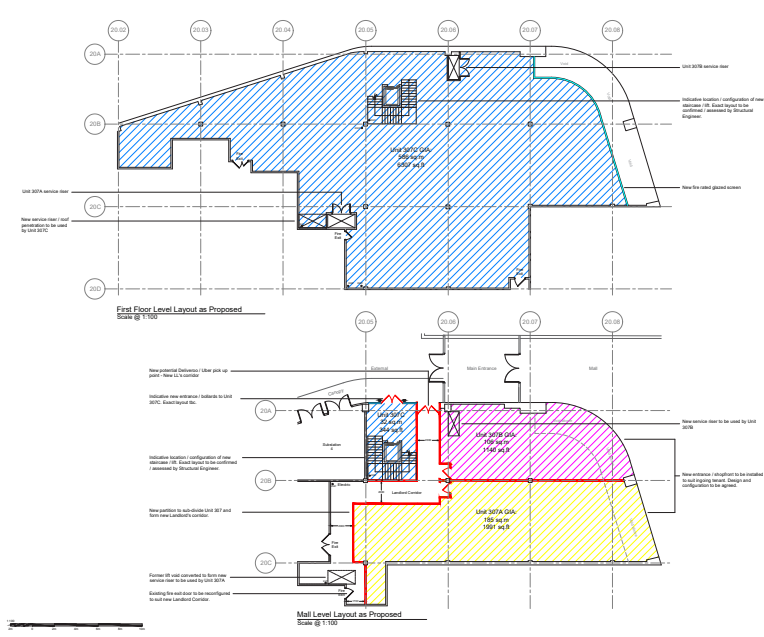

UNIT 301	sq.ft	sq.m
Ground Floor - Own Entrance, DDA lift & Stairs		
First Floor	49,109	350
Second Floor	6,139	350
TOTAL	55,248	667
RENT inc of Service Charge	£300,000	
RATEABLE VALUE	TBC	
SERVICE CHARGE	INC IN RENT	
INSURANCE	£23,763 + VAT	

UNIT 309	sq.ft	sq.m
Ground Floor	2,164	201
First Floor	1,940	180
TOTAL	4,104	381
RENT	£52,500	
RATEABLE VALUE	£34,400	
SERVICE CHARGE	£37,129 + VAT	
INSURANCE	£2,632 + VAT	

UNIT 308	sq.ft	sq.m
Ground Floor	3,411	317
First Floor	3,765	350
TOTAL	7,176	667
RENT	£65,000	
RATEABLE VALUE	£46,000	
SERVICE CHARGE	£65,469 + VAT	
INSURANCE	£4,604 + VAT	

UNIT 310	sq.ft	sq.m
Ground Floor	2,979	277
First Floor	843	78
TOTAL	3,822	355
RENT	£55,000	
RATEABLE VALUE	£40,600	
SERVICE CHARGE	£33,878 + VAT	
INSURANCE	£2,484 + VAT	

THE CENTRE OF THE COUNTRY

Livingston benefits from an outstanding location within Scotland's central belt and enjoys a wider residential catchment of some 371,944 people, of which 8,000 are students. The population of Livingston is expected to increase by a further 5.9% by 2028*.

* National Records for Scotland

- Primary catchment
- Secondary catchment
- Tertiary catchment

The Centre Livingston enjoys a prime location between the two cities of Edinburgh and Glasgow and benefits from 4 million people living within a 90 minute radius, of which 18% are Affluent Achievers.

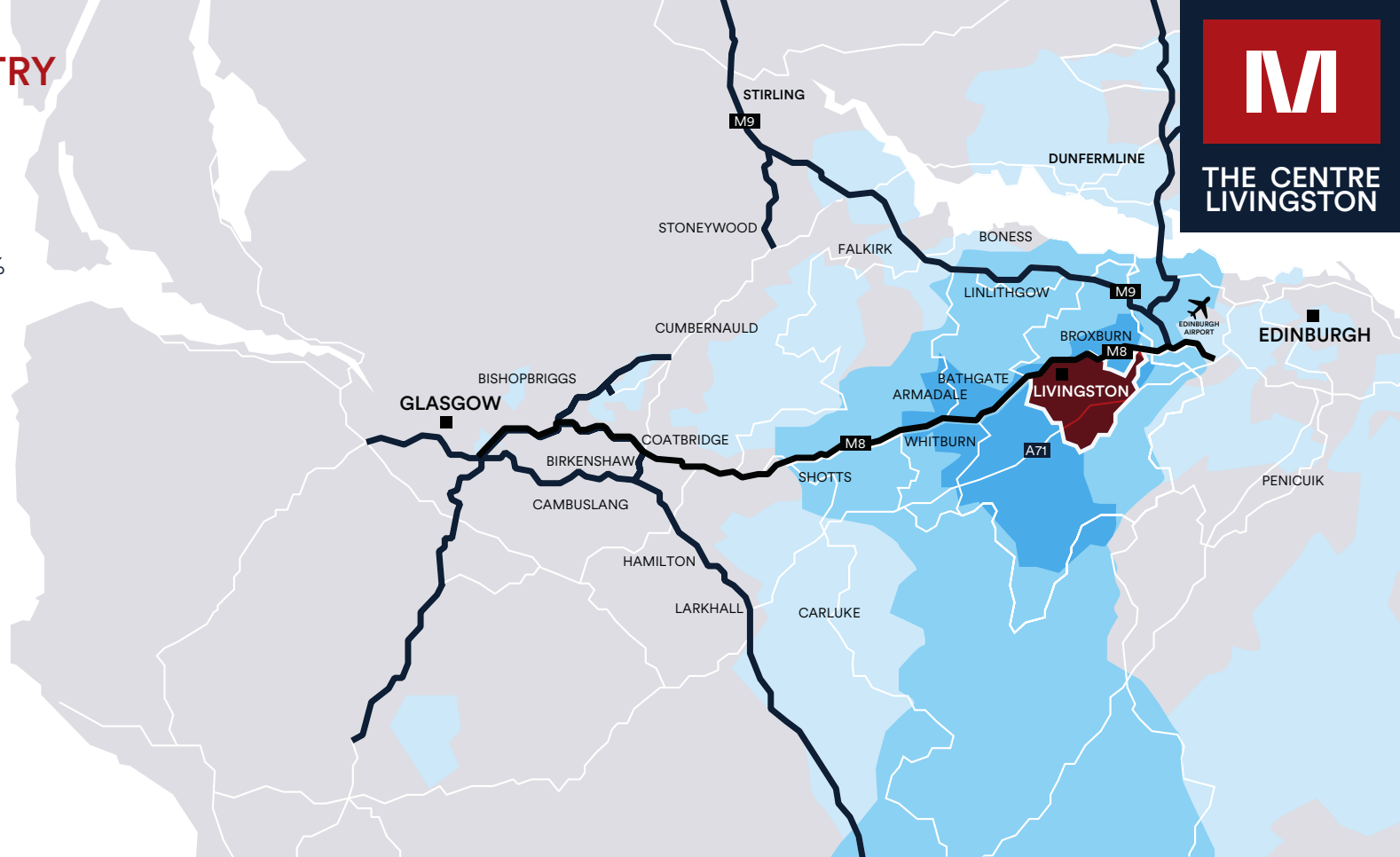

THE NAMES

With key fashion anchors including **Flannels**, **River Island**, **Primark**, **JD**, **M&S**, **H&M** and **Schuh**, the centre is the natural choice for the fashion-conscious shopper. Furthermore the centre is bolstered by other popular retailers such as **Boots**, **Superdrug**, **Sostrene Grene**, **Flying Tiger** and fabulous F&B outlets including **WingStop**, **Five Guys**, **Wagamama**, **Nando's**, **Subway** and **Greggs**. The Centre Livingston offers 7,200 car parking spaces and benefits from circa 1,283,000 visitors a month.



8k

Local Student Population

4m

Catchment Population within a 90 Minute Drive Time

136

Minutes Average Dwell Time in 2023

£99

Per Head Retail Spend in 2023

PRIME LOCATION

Situated just three miles from the M8 and nine miles from Edinburgh Airport. Livingston has key transport links to both Edinburgh and Glasgow by way of a central bus terminal, two train stations and connections to Scotland's central road network.

KIRKTON

Sat Nav: EH54 6QL
thecentrelivingston.com



MISREPRESENTATION ACT. 1967 London & Cambridge Properties Limited (Company Number 02895902) the registered office of which is at LCP House, Pensnett Estate, Kingswinford, West Midlands DY6 7NA its subsidiaries (as defined in section 1156 of the Companies Act 2006) associated companies and employees ("we") give notice that: Whilst these particulars are believed to be correct no guarantee or warranty is given, or implied therein, nor do they form any part of a contract. [We do our best to ensure all information in this brochure is accurate. If you find any inaccurate information, please let us know and where appropriate, we will correct it.] We make no representation that information is accurate and up to date or complete. We accept no liability for any loss or damage caused by inaccurate information. [This brochure gives a large amount of [statistical] information and there will inevitably be errors in it. Intending purchasers or tenants should not rely on the particulars in this brochure as statements or representations of fact but should satisfy themselves by inspection or otherwise as to the correctness of each of them. We provide this brochure free of charge and on the basis of no liability for the information given. In no event shall we be liable to you for any direct or indirect or consequential loss, loss of profit, revenue or goodwill arising from your use of the information contained herein. All terms implied by law are excluded to the fullest extent permitted by law. No person in our employment has any authority to make or give any representation or warranty whatsoever in relation to the property.

SUBJECT TO CONTRACT. We recommend that legal advice is taken on all documentation before entering into a contract. You should be aware that the Code of Practice on Commercial Leases in England and Wales strongly recommends you seek professional advice from a qualified surveyor, solicitor or licensed conveyancer before agreeing or signing a business tenancy agreement. The Code is available through professional institutions and trade associations or through the website <https://www.rics.org/uk/upholding-professional-standards/factor-standards/real-estate/code-for-leasing-business-premises-1st-edition/>. LCP's privacy notices that apply to its use of your personal information are at www.lcpgroup.co.uk/policies. The privacy notice that applies to you will depend on the nature of your relationship with LCP and in some cases more than one may apply to you. LCP's privacy policy giving a high level overview of how LCP approaches data protection and your personal information can be found at www.lcpproperties.co.uk/uploads/files/LCP-Privacy-Web-and-Data-Policy-May-2018.pdf.

36750 JUN26

LIVINGSTON
DESIGN OUTLET

vue

FLIBOUT

wetherspoon

ALMONDVALE
RETAIL PARK

Hollywood
Bowl

las
IGUANAS

wagamama

FIVE GUYS

Nando's

M
THE CENTRE
LIVINGSTON

M

THE CENTRE
LIVINGSTON

Viewing Strictly via prior appointment with the appointed agents:

Owned and managed by



Simon Eatough 07771 764148
SEatough@lcpproperties.co.uk



Stuart Moncur 07887 795506
Stuart.moncur@savills.com

Charlie Hall 07807 999693
Charlie.hall@savills.com

Michelle McLaughlin 07977 851507
Michelle.mclaughlin@savills.com



Alastair Rowe 07747 747280
arowe@eyco.co.uk

Alexandra Campbell 07425 335353
acampbell@eyco.co.uk

Ruari Hobkirk 07507 689448
rhobkirk@eyco.co.uk