

# StmW ST MARTIN'S WALK

M



## RETAIL UNITS TO LET

FROM  
**190 Sq.ft**  
(18 Sq.m)

[www.stmartinwalk.com](http://www.stmartinwalk.com)



St Martin's Walk, Dorking, Surrey, RH4 1UX

## PARKING & TRANSPORT

- Dorking, Dorking Deepdene and Dorking West. Services connect to mainline stations Waterloo, London Victoria, Horsham, Gatwick, Redhill and Guildford.
- Parking for over 400 vehicles.
- Bike racks.
- 11 minute walk to train station.



## DESCRIPTION

- Situated in Dorking in an area of outstanding beauty.
- Prime location.
- 25 retailers and food outlets.
- Free public toilets & baby changing facilities.
- The centre benefits from a mix of local retailers and multiples well as a regular farmers' market and is anchored by **Marks & Spencer** and the council run library.

## LOCATION – RH4 1UX

Dorking is at the junction of the A24 (London to Worthing) and A25 (Maidstone to Guildford) roads.



SITE PLAN

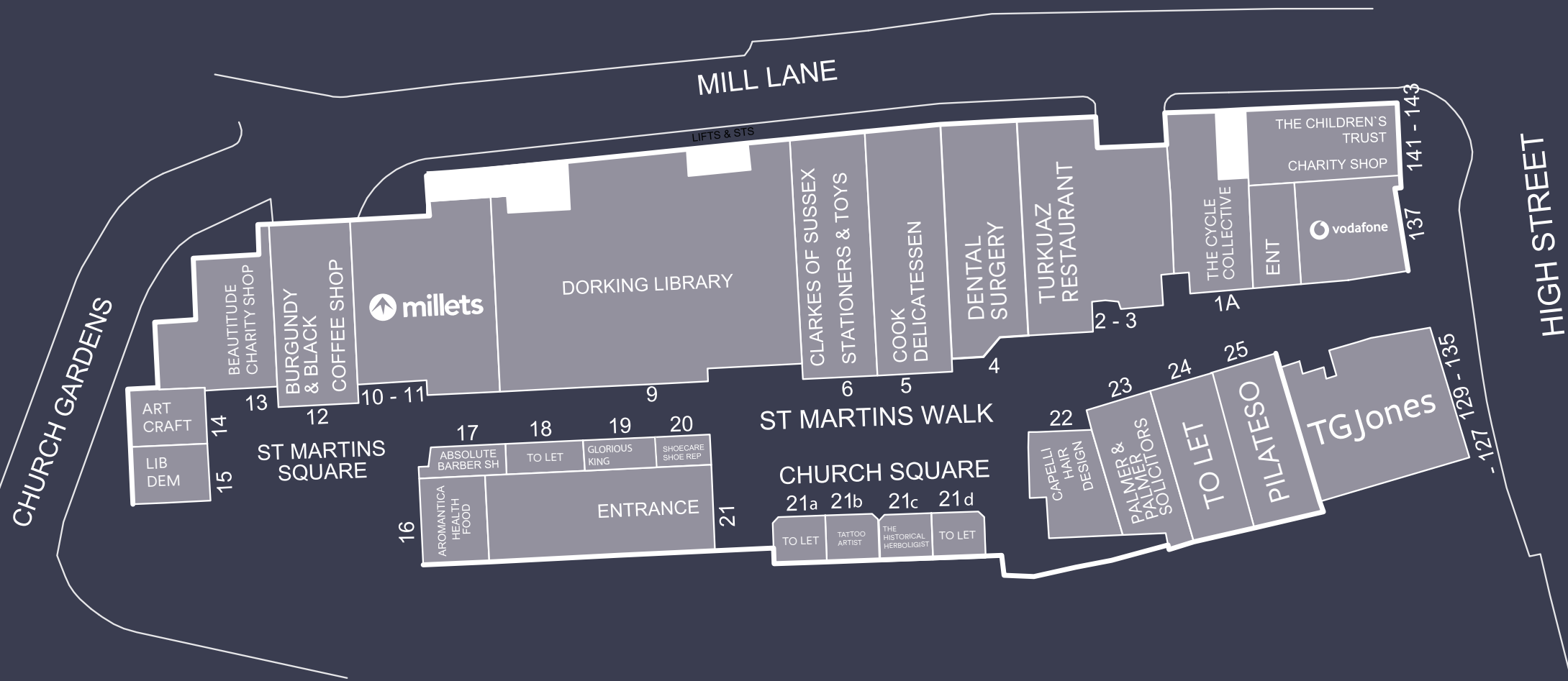

Stmw ST MARTIN'S WALK 



# RETAIL UNITS TO LET

[www.stmartinwalk.com](http://www.stmartinwalk.com)



## RATES

Rateable Value is subject to change in April 2023.

## SERVICE CHARGE

Current service charge TBC.

## PLANNING

The premises benefits from a new E use class (commercial, business and service) including retail. Interested parties are advised to make their own enquiries of the Local Planning Authority.

## INSURANCE

The Landlord will insure the premises the premiums to be recovered from the tenant.

## ENERGY PERFORMANCE

Further information available upon request.

## LEGAL COSTS

Each party is responsible for their own legal costs in connection with the granting of the lease.

### MISREPRESENTATION ACT 1967

1967 London & Cambridge Properties Limited (Company Number 02895002) the registered office of which is at LCP House, Pensnett Estate, Kingswinford, West Midlands DY6 7NA its subsidiaries (as defined in section 1156 of the Companies Act 2006) associated companies and employees ("we") give notice that: Whilst these particulars are believed to be correct no guarantee or warranty is given, or implied therein, nor do they form any part of a contract. [We do our best to ensure all information in this brochure is accurate. If you find any inaccurate information, please let us know and where appropriate, we will correct it.] We make no representation that information is accurate and up to date or complete. We accept no liability for any loss or damage caused by inaccurate information. [This brochure gives a large amount of [statistical] information and there will inevitably be errors in it]. Intending purchasers or tenants should not rely on the particulars in this brochure as statements or representations of fact but should satisfy themselves by inspection or otherwise as to the correctness of each of them. We provide this brochure free of charge and on the basis of no liability for the information given. In no event shall we be liable to you for any direct or indirect or consequential loss, loss of profit, revenue or goodwill arising from your use of the information contained herein. All terms implied by law are excluded to the fullest extent permitted by law. No person in our employment has any authority to make or give any representation or warranty whatsoever in relation to the property.

### SUBJECT TO CONTRACT

We recommend that legal advice is taken on all documentation before entering into a contract. You should be aware that the Code of Practice on Commercial Leases in England and Wales strongly recommends you seek professional advice from a qualified surveyor, solicitor or licensed conveyancer before agreeing or signing a business tenancy agreement. The Code is available through professional institutions and trade associations or through the website <https://www.rics.org/uk/upholding-professional-standards/sector-standards/real-estate/code-for-leasing-business-premises-1st-edition/>. LCP's privacy notices that apply to its use of your personal information are at [www.lcpgroup.co.uk/policies](http://www.lcpgroup.co.uk/policies). The privacy notice that applies to you will depend on the nature of your relationship with LCP, and in some cases more than one may apply to you. LCP's privacy policy giving a high level overview of how LCP approaches data protection and your personal information can be found at [www.lcpproperties.co.uk/uploads/files/LCP-Privacy-Web-and-Data-Policy-May-2018.pdf](http://www.lcpproperties.co.uk/uploads/files/LCP-Privacy-Web-and-Data-Policy-May-2018.pdf).

## LETTING AGENT



Steve Lane 01737 229201  
sjl@robinsonsmb.com  
[www.robinsonsmb.com](http://www.robinsonsmb.com)

Owned and Managed by

**SHEET ANCHOR  
EVOLVE**

part of IMCore

020  
7228  
6508

[sheetanchorevolve.com](http://sheetanchorevolve.com)



Michael Tsimekis 07901 299 442  
[mtsimekis@saevolve.com](mailto:mtsimekis@saevolve.com)