



TO LET

Industrial / Warehouse Unit

6,451 sq.ft (599.3 sq.m)

Unit 3, Cumbernauld Business Park, 3 Wardpark Road, North Lanarkshire, G67 3JZ

- Located south-east of the M80
- Modern mid terrace unit
- Roller shutter door
- Private yard/parking area to the front

M **M[®]Core**
LCP UK

01384
400123

lcpgroup.co.uk



Unit 3, Cumbernauld Business Park, 3 Wardpark Road, North Lanarkshire, G67 3JZ

Areas (Approx. Gross Internal)

Warehouse	6,451 sq.ft	(599.3 sq.m)
Total	6,451 sq.ft	(599.3 sq.m)

Location - G67 3JZ

Located at Junction 6 of the M80 motorway 15 Miles north east of Glasgow City Centre. 15 Miles south of Stirling and within the Wardpark industrial area.

Description:

Modern mid terrace industrial building with private yard/parking area to the front. Office section and WCs. Minimum Eaves Height 4.40m (rising to 5.70m).

Rent

Guide rent of £48,400 subject to lease terms and covenant.

Service Charge

There is a service charge arrangement in place TBC pa.

Business Rates

TBC.

All parties to make their own enquiries with North Lanarkshire Council.

Insurance

The Landlord will insure the premises the premiums to be recovered from the tenant.

Energy Performance

Furthr information available on request.

Planning

All interested parties are to make their own specific enquiries directly with the Local Planning Authority as to their intended use.

Legal and Surveyor Costs

Each party will be responsible for their own legal and surveyors costs incurred with the proposed transaction.

Anti Money Laundering (AML)

To comply with AML Regulations, identification checks and confirmation of source of funding is required from any lessee.

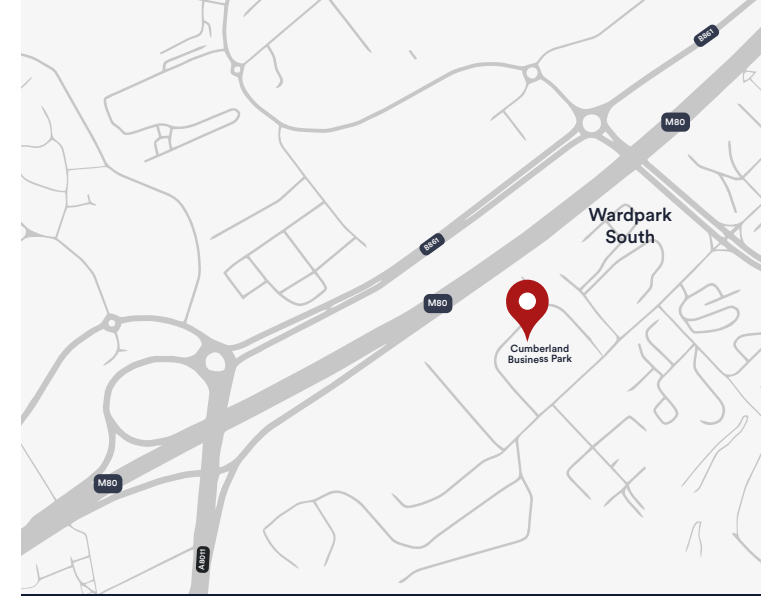
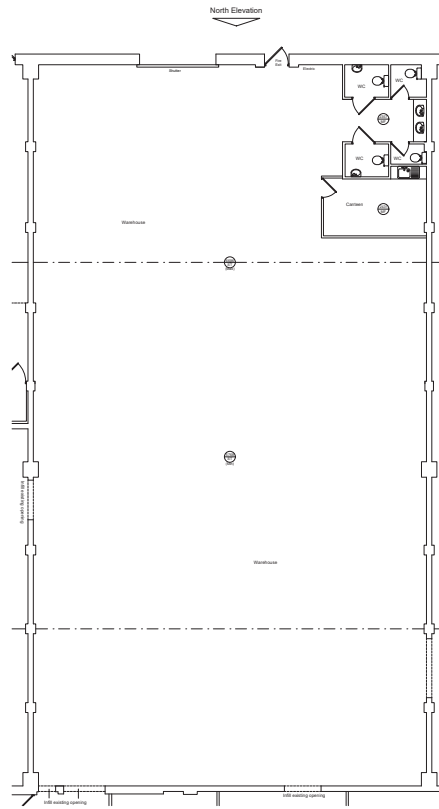

Viewing

Strictly via prior appointment with the appointed agents



0141 226 1000

colliers.com/uk/industrial

Colin McManus

07795 613 227

Colin.McManus@colliers.com

Ryden.co.uk

0131 225 6612

Gregor Harvie

07765 255988

gregor.harvie@ryden.co.uk



Alex Williams

07741 951843

AWilliams@lcpproperties.co.uk

MISREPRESENTATION ACT, 1967 London & Cambridge Properties Limited (Company Number 02895002) the registered office of which is at LCP House, Pensnett Estate, Kingswinford, West Midlands DY6 7NA its subsidiaries (as defined in section 1156 of the Companies Act 2006) associated companies and employees ("we") give notice that: Whilst these particulars are believed to be correct no guarantee or warranty is given, or implied therein, nor do they form any part of a contract. [We do our best to ensure all information in this brochure is accurate. If you find any inaccurate information, please let us know and where appropriate, we will correct it.] We make no representation that information is accurate and up to date or complete. We accept no liability for any loss or damage caused by inaccurate information. [This brochure gives a large amount of [statistical] information and there will inevitably be errors in it]. Intending purchasers or tenants should not rely on the particulars in this brochure as statements or representations of fact but should satisfy themselves by inspection or otherwise as to the correctness of each of them. We provide this brochure free of charge and on the basis of no liability for the information given. In no event shall we be liable to you for any direct or indirect or consequential loss, loss of profit, revenue or goodwill arising from your use of the information contained herein. All terms implied by law are excluded to the fullest extent permitted by law. No person in our employment has any authority to make or give any representation or warranty whatsoever in relation to the property. SUBJECT TO CONTRACT. We recommend that legal advice is taken on all documentation before entering into a contract. You should be aware that the Code of Practice on Commercial Leases in England and Wales strongly recommends you seek professional advice from a qualified surveyor, solicitor or licensed conveyancer before agreeing or signing a business tenancy agreement. The Code is available through professional institutions and trade associations or through the website <https://www.rics.org/uk/upholding-professional-standards/sector-standards/real-estate/code-for-leasing-business-premises-1st-edition/>. LCP's privacy notices that apply to its use of your personal information are at www.lcpgroup.co.uk/policies. The privacy notice that applies to you will depend on the nature of your relationship with LCP, and in some cases more than one may apply to you. LCP's privacy policy giving a high level overview of how LCP approaches data protection and your personal information can be found at www.lcpproperties.co.uk/uploads/files/LCP-Privacy-Web-and-Data-Policy-May-2018.pdf.