



M THE PRECINCT

///riverside.whispers.crusted
The Precinct
Portishead
BS20 6AH

Occupiers Include



THE PRECINCT

DESCRIPTION

Nestled just off the bustling High Street in the heart of Portishead, The Precinct offers a vibrant mix of retail units in one of North Somerset's most desirable locations. This well-established shopping destination benefits from high footfall, excellent visibility, and a strong tenant mix including national brands such as Specsavers, Parsons Bakery, Coffee #1, and Johnsons Cleaners.

- Prime location just off Portishead High Street
- Anchored by Iceland supermarket
- Surrounded by popular national and local retailers
- On-site and nearby parking options
- Excellent transport links to the M5 and Bristol

LOCATION

Portishead is a popular coastal town situated 10 miles west of Bristol. Access to J19 of the M5 motorway is approximately 3 miles from the premises.

The town has a population of circa 25,000 that is set to swell to over 30,000 in the coming years, which has led to a strong High Street offering with the likes of Costa, Loungers, Greggs, Co-op and Parsons all represented.



13

Retail Units On-Site



19,769 sq.ft

Total Area



What Three Words

riverside.whispers.crusted

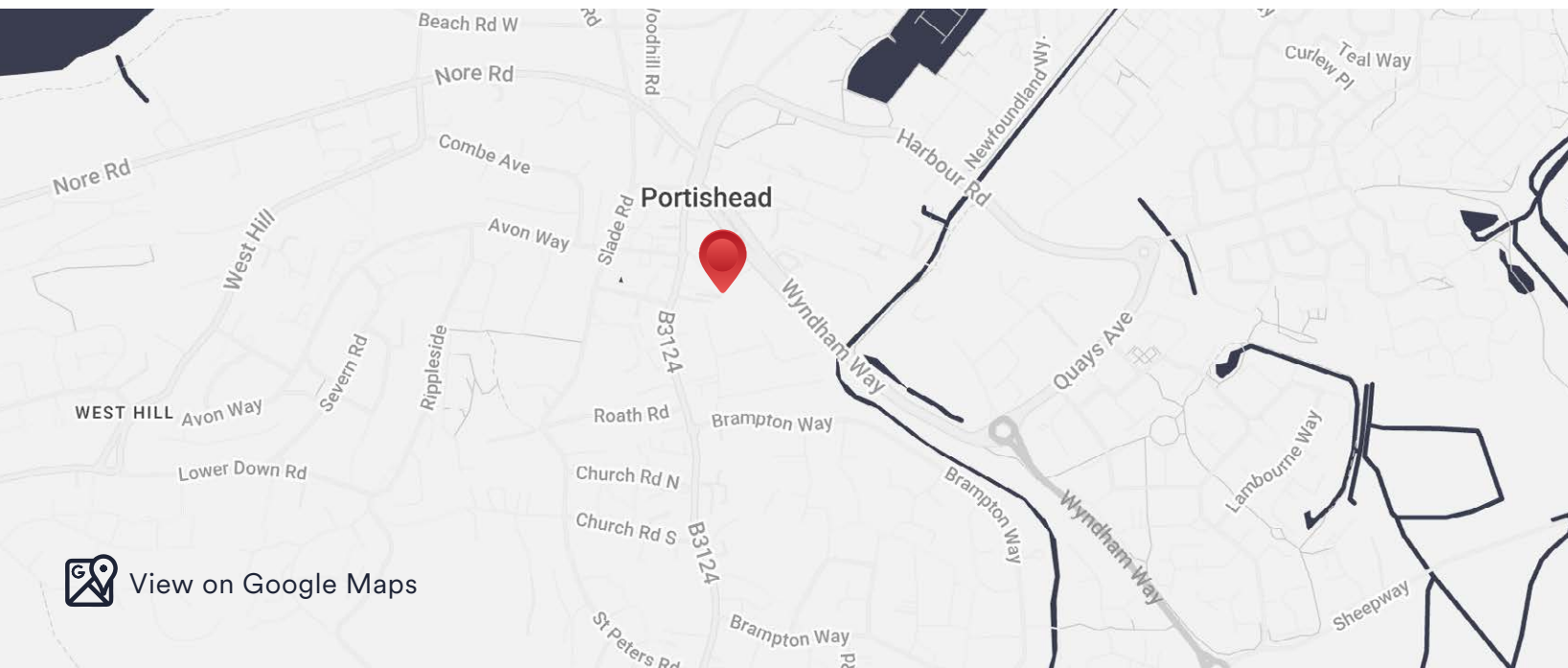

View on Google Maps

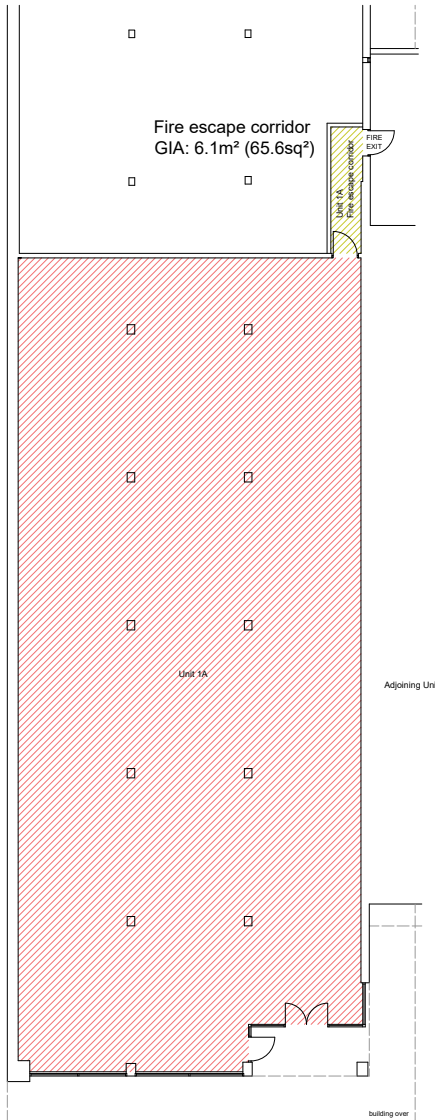

Ground Floor Plan
GIA: 430.5m² (4633.8sq²)

UNIT 1A

SIZE

4,333 sq.ft (430.4 sq.m)

RENT

£52,500 pa

SERVICE CHARGE

£6,800 pa

RATEABLE VALUE

£37,800 pa

EPC

EPC - E.

Further information available upon request.

PLANNING

Subject to planning. It is the ingoing tenant's responsibility to verify that their intended use is acceptable to the Local Planning Authority.

LEGAL COSTS

Each party is responsible for their own legal costs in connection with the granting of a lease.

DISCLAIMER

Please note that occupational costs are approximate.

M THE PRECINCT



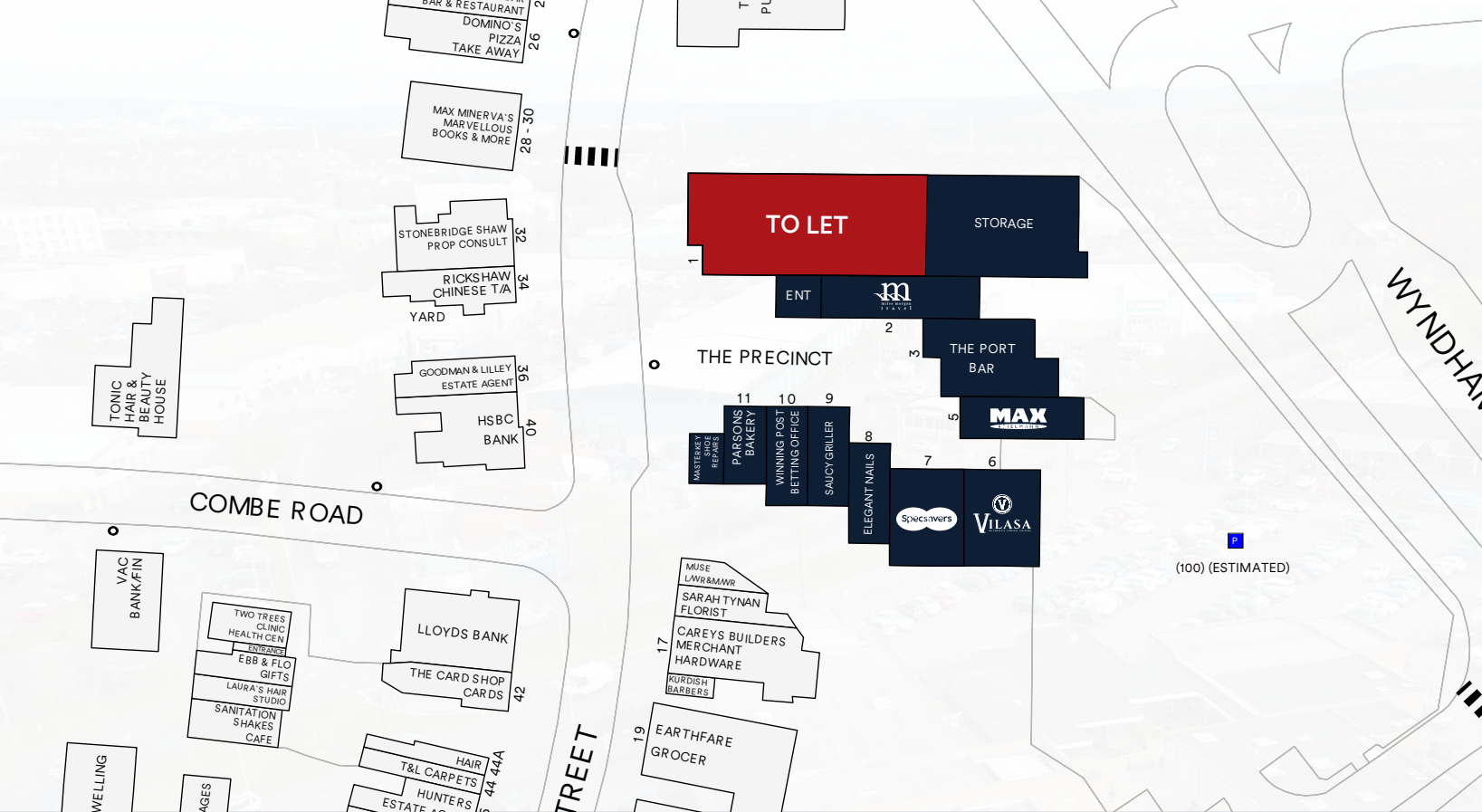

Adam Martin

07825 091440
AMartin@lcpproperties.co.uk

**Hartnell
Taylor Cook**

James Woodard

07753 302236
James.Woodard@htc.uk.com

SERVICES



Bicycle Parking



**Parcel Delivery
Lockers**



**8 EV Chargers
on site**



**Free Onsite Parking
(first two hours)**



100+ Parking Spaces
plus additional staff parking
and delivery areas



MISREPRESENTATION ACT, 1967 London & Cambridge Properties Limited (Company Number 02895002) the registered office of which is at LCP House, Pennant Estate, Kingsthorpe, West Midlands O16 7NA its subsidiaries (as defined in section 1166 of the Companies Act 2006) associated companies and employees (we) give notice that: Whilst these particulars are believed to be correct no guarantee or warranty is given, or implied therein, nor do they form any part of a contract. [We do our best to ensure all information in this brochure is accurate. If you find any inaccurate information, please let us know and where appropriate, we will correct it.] We make no representation that information is accurate and up to date or complete. We accept no liability for any loss or damage caused by inaccurate information. [This brochure gives a large amount of statistical information and there will inevitably be errors in it. Intending purchasers or tenants should not rely on the particulars in this brochure as statements or representations of fact but should satisfy themselves by inspection or otherwise as to the correctness of each of them. We provide this brochure free of charge and on the basis of no liability for the information given. In no event shall we be liable to you for any direct or indirect or consequential loss, loss of profit, revenue or goodwill arising from your use of the information contained herein. All terms implied by law are excluded to the fullest extent permitted by law. No person in our employment has any authority to make or give any representation or warranty whatsoever in relation to the property. SUBJECT TO CONTRACT. We recommend that legal advice is taken on all documentation before entering into a contract. You should be aware that the Code of Practice on Commercial Leases in England and Wales strongly recommends you seek professional advice from a qualified surveyor, solicitor or licensed conveyancer before agreeing or signing a business tenancy agreement. The Code is available through professional institutions and trade associations or through the website <https://www.lcp.co.uk/uk/upholding-professional-standards/sector-standards/real-estate/code-for-leasing-business-premises-1st-edition/>. LCP's privacy notices that apply to its use of your personal information are at www.lcpgroup.co.uk/policies. The privacy notice that applies to you will depend on the nature of your relationship with LCP, and in some cases more than one may apply to you. LCP's privacy policy giving a high level overview of how LCP approaches data protection and your personal information can be found at www.lcpproperties.co.uk/uploads/files/LCP-Privacy-Web-and-Data-Policy-May-2018.pdf.