

TO LET/MAY SELL

OFFERS IN EXCESS OF
£580,000



M UNIT 2-4

Palmerston Road
Southsea, Hampshire
Portsmouth, PO5 3QH

Local Occupiers Include



PALMERSTON ROAD

UNIT 2-4

DESCRIPTION

The property is situated in the heart of Southsea in a prime retailing position on the western side of Palmerston Road, which is fully pedestrianised.

- Prime retailing position in Southsea
- Public car parking nearby
- Tenants include Specsavers, Costa, Waitrose, Boots, WH Smiths, and Tesco Express

AREAS (Approx. Gross Internal)

Sales Area	1,949 sq.ft	(181 sq.m)
Ancillary	172 sq.ft	(16 sq.m)
TOTAL	2,121 sq.ft	(197 sq.m)

PRICE & RENT

Offers in excess of £580,000
Rent £40,750 +VAT

BUSINESS RATES

Rateable Value: £40,750

SERVICES

All mains services are available

SERVICE CHARGE & INSURANCE

Service Charge: £750 per annum. Insurance to be confirmed

ENERGY PERFORMANCE

EPC rating C. Further information available upon request

PLANNING

Subject to planning. It is the ingoing tenant's responsibility to verify that their intended use is acceptable to the Local Planning Authority

LEGAL COSTS

Each party is responsible for their own legal costs in connection with the granting of a lease

FLOOR PLAN

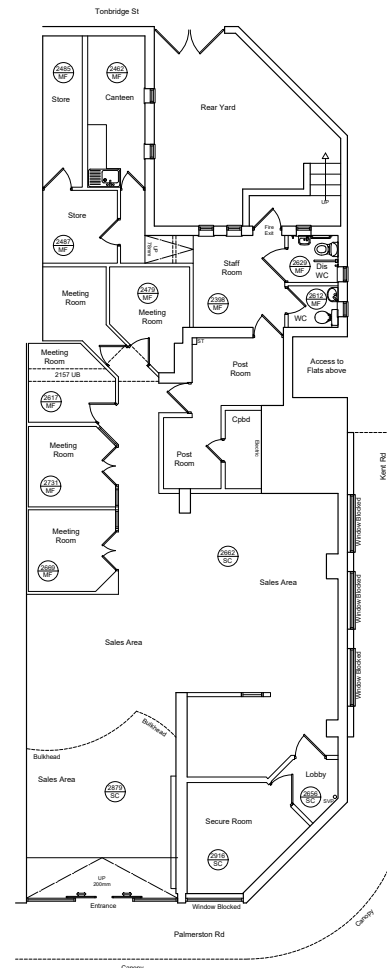

17

Retail Units On-Site



42,802 sq.ft

Total Area



What Three Words
paper.normal.hats

